

Know your coffee maker

Please read these instructions and have a good look at the illustrations before using your coffee maker.

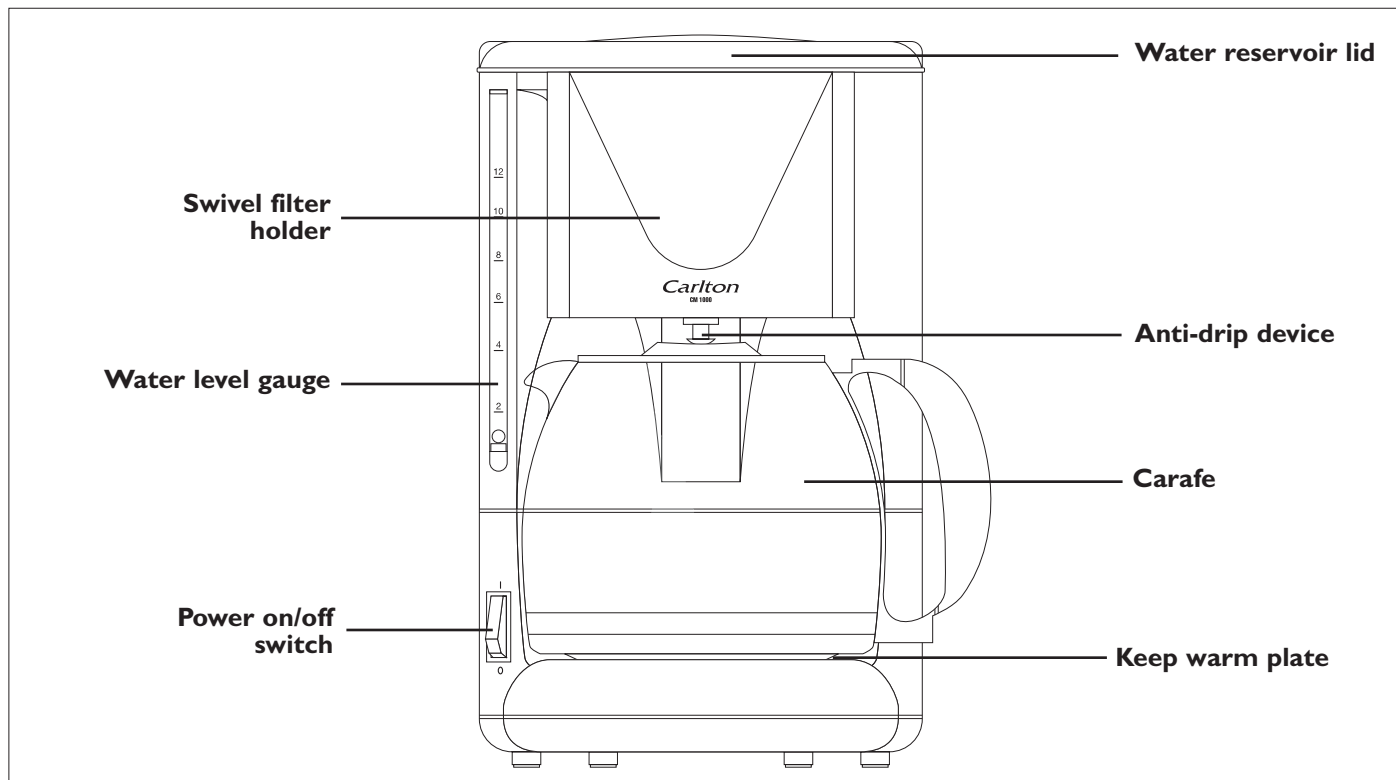

Safety first !



Stand your coffee maker on a stable, level surface during use.

Do not place or store your coffee maker where it can fall or be pulled into water or any other liquid.

Do not reach for the appliance if it has fallen in any water or any other liquid. Unplug immediately.

Do not use any other carafe other than the one supplied.

Do not fill your coffee maker with any liquid other than water and do not attempt to switch it on if the maximum level is exceeded.

If the mains cord of this appliance is damaged, it must be replaced (contact your nearest store).



Make sure that children cannot touch the coffee maker when hot or pull the mains lead.

It is **DANGEROUS** to place fingers or objects other than the carafe provided on the warming plate. Do not allow young children to play with your coffee maker.

This coffee maker is intended for home use only. It is not to be used in commercial catering conditions.



Caution - Steam can be produced when using your coffee maker.

Be careful when opening the lid of your coffee maker - it can be hot.

Your coffee maker should be placed away from heat sources such as radiators, gas/electric fires and direct sunlight.

Do not allow the mains lead or any other combustible material to come into contact with the warming plate.

Keep the power cord away from any heated surfaces.

Unplug the appliance from the mains supply before cleaning.

Use the appliance only for its intended use, as described in this manual.

Do not use outdoors.



Never use your coffee maker if it is damaged in any way.

Do not remove any fixed covers. Never use this appliance if it is not working properly, or if it has been dropped or damaged.



Your coffee maker is supplied with an approved 13 amp fused mains plug. When replacing the fuse always use a 13 amp^(BS1362) approved type.

If the mains sockets in your home differ or are not suitable for the type of plug supplied, then the plug should be removed and a suitable type fitted.

Please refer to the wiring instructions at the back of this book.

Before using your coffee maker...

Follow the steps below before attempting to make coffee with your coffee maker. Using filtered water with your coffee maker will reduce limescale build up, improve the taste of your coffee and increase your coffee maker's life.

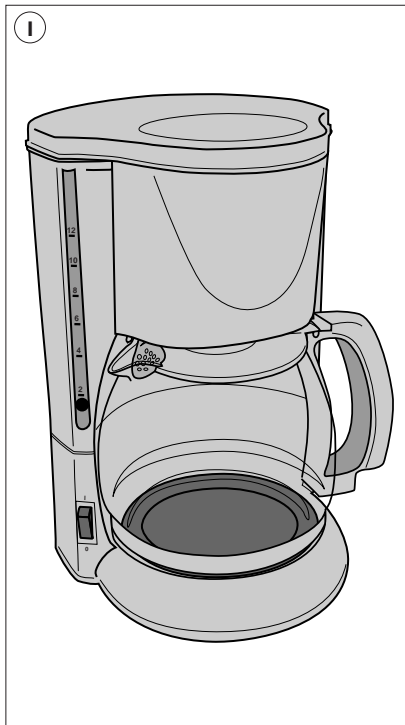

Wash the filter holder, carafe and lid in hot soapy water. Rinse and dry before use.

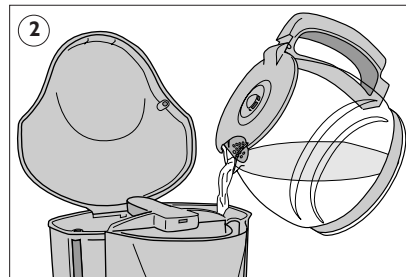

Fill the water reservoir to the maximum level (12) with cold water. Do not overfill.

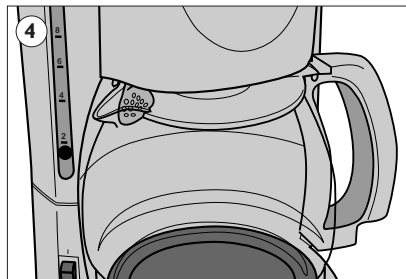

Allow the water to flow through the coffee maker. Then repeat steps 2 to 4.

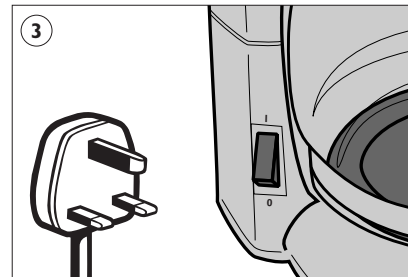

Plug in and switch on the coffee maker.



Do not immerse coffee maker in water.

How to make coffee using your coffee maker

To make coffee, water will pass slowly through the grounds, this can take up to 10 minutes for a full carafe.

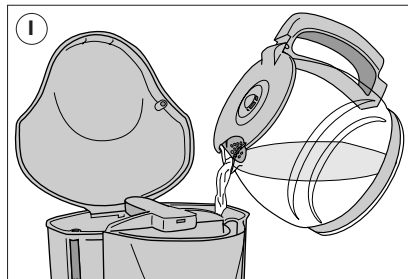

Using the carafe measure the required amount of cold water. Add the water to the reservoir of your coffee maker.

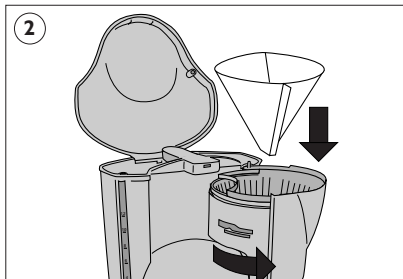

Swing out the filter holder and insert a suitable filter paper into the filter cone.



Put the measured quantity of coffee into the filter paper and close the holder.
The measure of coffee per cup should be adjusted to suit your taste.

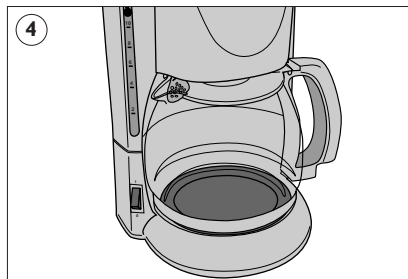

Replace carafe and switch on the coffee maker.
The carafe may be removed briefly during the brewing process.

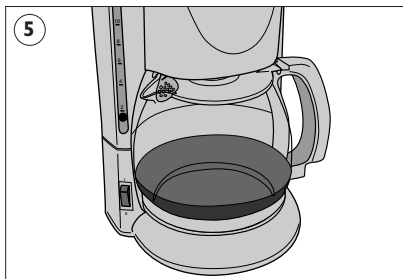

After serving, return any unused coffee to the **keep warm plate**.

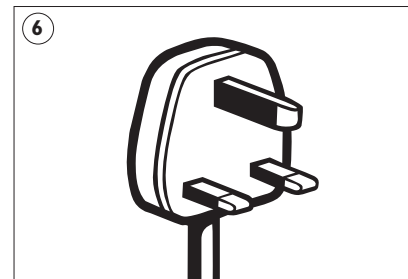

If the *keep warm plate* is no longer required switch off the coffee maker and remove the plug from the power supply.

Cleaning and Care

Do not clean the main part of the coffee maker under running water. Do not immerse in water or liquid of any kind. Do not use harsh cleaners or solvents as they may damage the casing.



Remove plug from socket.

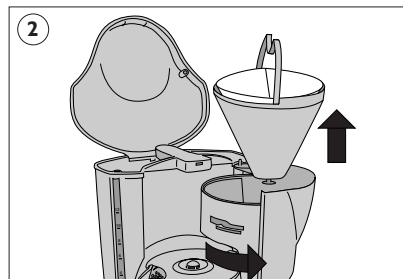

Swing out the filter holder and remove the filter cone. Discard used grounds and filter paper.

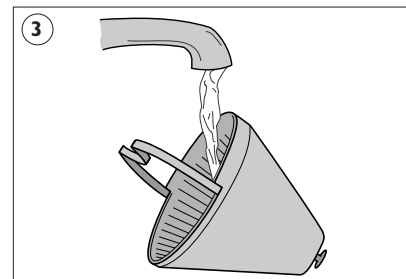

Clean the filter cone under running water.

In addition - the filter holder can be removed for cleaning under running water...

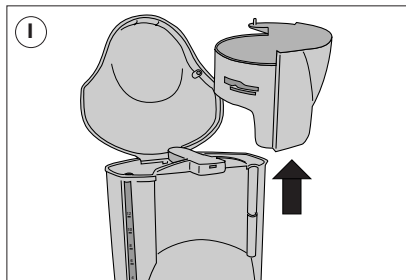

Swing out the holder and lift it at the pivot.

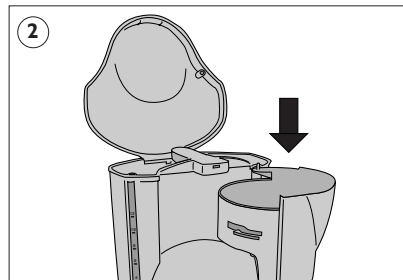

Replace the holder by inserting the pivot and lowering into position.



The body of the unit should be cleaned using a cloth dampened with warm water.

Descaling your coffee maker

If you live in a hard water area, descale the coffee maker occasionally with a cleaning agent. The frequency required depends on the hardness of your water and how often the coffee maker is used. An indication of 'furring up' is when the coffee takes much longer to brew.

Switch the coffee maker on, then allow the cleaning agent to flow through into the carafe (without filter fitted) avoid letting the solution drip onto the keep warm plate.

Empty the used solution and rinse the carafe well. Let the maximum amount of clean water flow through several times to avoid affecting the taste and aroma of your coffee.

WARNING

Use the descaler according to the manufacturers instructions, these cleaning agents are generally caustic.

Wiring Instructions

Warning! this appliance must be Earthed

The wires in your coffee maker mains lead are coloured in accordance with the following:-

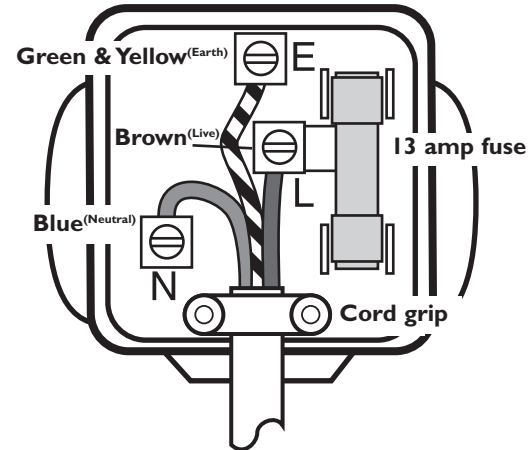

The wire which is coloured **Blue** must be connected to the terminal in the plug which is marked with the letter **N** or coloured **Black**.

The wire which is coloured **Brown** must be connected to the terminal in the plug which is marked with the letter **L** or coloured **Red**.

The wire which is coloured **Green and Yellow** must be connected to the terminal in the plug which is marked with the letter **E** or by the Earth symbol or coloured **Green** or **Green and Yellow**.

You must use a **13 amp plug**^(BS 1363), and fit a **13 amp fuse**^(BS 1362). If any other type of plug is used a **13 amp fuse** must be fitted, either in the plug, adaptor or at the distribution board.

Nominal Specifications

Power Supply	230-240V ~ 50Hz
Power consumption	900W

No part of this publication may be produced, stored in a retrieval system or transmitted in any form or by any means, without the prior permission in writing of Dixons Stores Group, nor be otherwise circulated in any form or binding or cover other than that in which it is published and without a similar condition including this condition being imposed on the subsequent purchaser.